

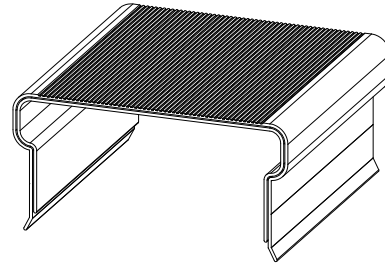

AW-1075 STR Cap



Drawn: JAB Date: 06/18/09

Section Modulus (Z)	20.8 in ³	341 cm ³
Moment of Inertia (I)	128 in ⁴	5,328 cm ⁴
Outside Width	12.3 in	312 mm
Inside Width	10.15 in	258 mm
Material	6063-T6 Marine Grade Aluminum	
Sheet Piling Compatibility	SG-525, SG-625, SG-650, SG-750, CL-9000, CL-9900, Flat Panel, GG-50	
Tie Rod Compatibility	AW 2.5" x 0.75" Rod Kit, AW 2.9" x 1" Rod Kit	
Recommended Accessories	Beveled PVC Washer, 45° and 90° AW-1075 Corner Insert	
Standard Colors/Surface Treatment	Mill Finish, Grey, Clay, Anodized Marine Bronze	
Standard Packaging	20ft AW-1075 Cap, SS and PVC Fasteners, 20ft Structural Insert	

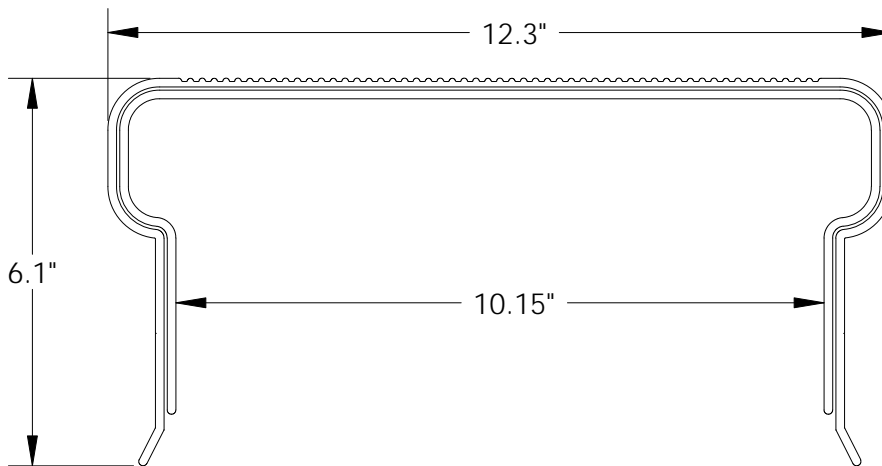

Physical properties are defined by ASTM testing standards, The Aluminum Association Design Manual, and/or standard engineering practice. The values shown are nominal and may vary. The information found in this document is believed to be true and accurate. No warranties of any kind are made as to the suitability of any CMI product for particular applications or the results obtained there from. ShoreGuard, C-Loc, TimberGuard, GeoGuard, Dura Dock, Shore-All, and Gator Gates are registered trademarks of Crane Materials International. ArmorWare, Ultra Composite, GatorDocks, GatorBridge and CMI Waterfront Solutions are trademarks of Crane Materials International. United States and International Patent numbers 5,145,287; 6,000,883; 6,033,155; 6,053,666; D420,154; 6,575,667; 7,059,807; 7,056,066; 7,025,539; 7,393,482; Other patents pending. © 2009 Crane Materials International. All Rights Reserved.