

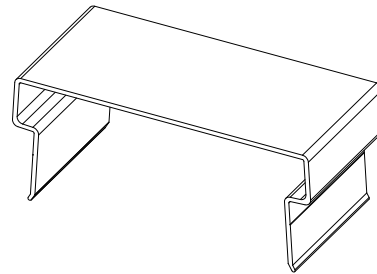

SC-15 Cap



Drawn: JAB Date: 06/18/09

Section Modulus (Z)	16.5 in ³	270 cm ³
Moment of Inertia (I)	103 in ⁴	4,287 cm ⁴
Outside Width	12.5 in	318 mm
Inside Width	10.10 in	257 mm
Material	6061-T6 Marine Grade Aluminum	
Sheet Piling Compatibility	PZH-153, PZH-159	
Tie Rod Compatibility	AW 2.5" x 0.75" Rod Kit	
Recommended Accessories	45° and 90° SC-15 Corner Insert	
Standard Colors/Surface Treatment	Mill Finish	
Standard Packaging	25ft SC-15 Cap, SS and Nylon Fasteners, Splice Insert	

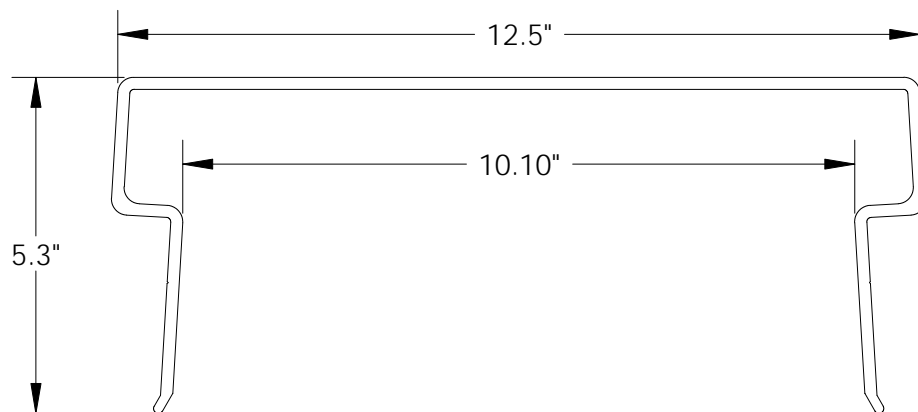

Physical properties are defined by ASTM testing standards, The Aluminum Association Design Manual, and/or standard engineering practice. The values shown are nominal and may vary. The information found in this document is believed to be true and accurate. No warranties of any kind are made as to the suitability of any CMI product for particular applications or the results obtained there from. ShoreGuard, C-Loc, TimberGuard, GeoGuard, Dura Dock, Shore-All, and Gator Gates are registered trademarks of Crane Materials International. ArmorWare, Ultra Composite, GatorDocks, GatorBridge and CMI Waterfront Solutions are trademarks of Crane Materials International. United States and International Patent numbers 5,145,287; 6,000,883; 6,033,155; 6,053,666; D420,154; 6,575,667; 7,059,807; 7,056,066; 7,025,539; 7,393,482; Other patents pending. © 2009 Crane Materials International. All Rights Reserved.