

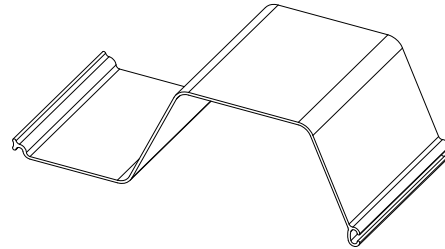

AWM-3



Drawn: JAB Date: 06/18/09

MAX Allowable Moment (M)	3,575 ft-lb/ft	15.90 kN-m/m
Section Modulus (Z)	2.2 in ³ /ft	118 cm ³ /m
Moment of Inertia (I)	4.4 in ⁴ /ft	601 cm ⁴ /m
Thickness (t)	0.095 in	2.4 mm
Section Depth	4.0 in	102 mm
Section Width	12 in	305 mm
Design Modulus of Elasticity (E)	10 x 10 ⁶ psi	68,900 Mpa
Material	6061-T6 Marine Grade Aluminum	
Standard Colors	Mill Finish	
Profile/Patented Features	Pan Profile	

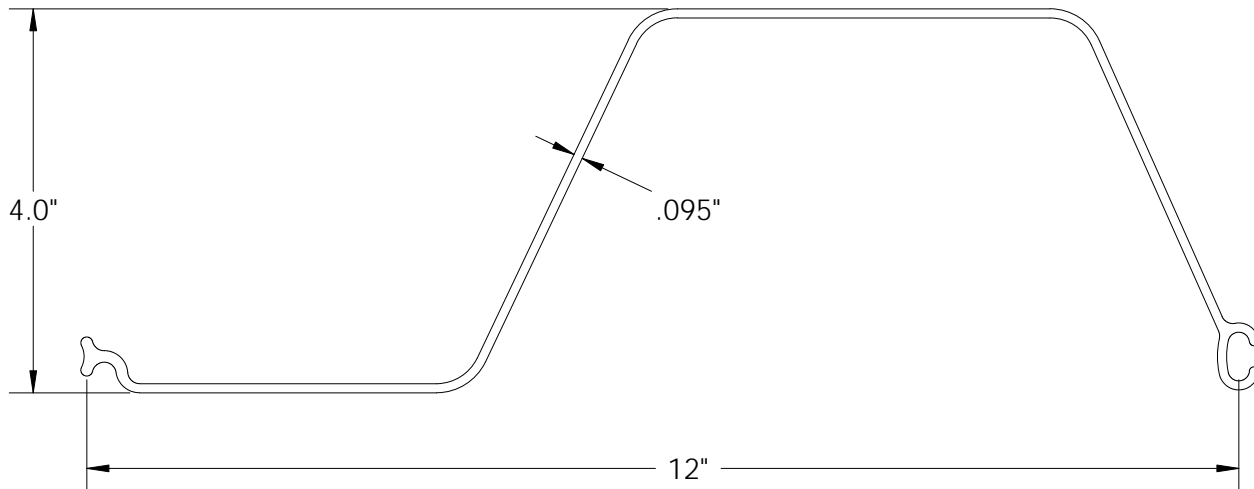

Physical properties are defined by ASTM testing standards, The Aluminum Association Design Manual, and/or standard engineering practice. The values shown are nominal and may vary. The information found in this document is believed to be true and accurate. No warranties of any kind are made as to the suitability of any CMI product for particular applications or the results obtained there from. ShoreGuard, C-Loc, TimberGuard, GeoGuard, Dura Dock, Shore-All, and Gator Gates are registered trademarks of Crane Materials International. ArmorWare, Ultra Composite, GatorDocks, GatorBridge and CMI Waterfront Solutions are trademarks of Crane Materials International. United States and International Patent numbers 5,145,287; 6,000,883; 6,033,155; 6,053,666; D420,154; 6,575,667; 7,059,807; 7,056,066; 7,025,539; 7,393,482; Other patents pending. © 2009 Crane Materials International. All Rights Reserved.