



TimberGuard® Dimensional Timber

TG 6x8 Wale Specification

Crane Materials International

www.cmiengineer.com (866) 867-3762

TG 6 x 8 Wale

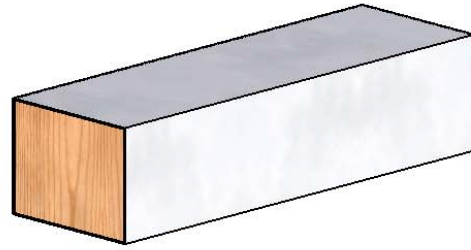

Drawn: JAB Date: 06/18/09

Moment of Inertia (I) (weak axis)	101 in ⁴	4,204 cm ⁴
Core Material	No. 2 Southern Pine	
Surface Material	UV Resistant Polymer	
Recommended Accessories	90° Corner Brace, AW Rod Kits, TG End Cap, TG Wrap, TG Sealant	
Available Lengths	16 ft, 20 ft	
Standard Colors	Clay, Grey, Brown	

Polymer Properties

Resin Properties	ASTM Test Method	Typical Values
Density (lbs/ft ³)	D-4883	59.3
Tensile Strength at Yield (psi)	D-638	3,900
Tensile Strength at Break (psi)	D-638	2,200
Elongation at Yield (%)	D-638	9
Elongation at Break (%)	D-638	600
Tensile Modulus (psi)	D-638	600
Flexural Modulus (psi)	D-790	260,000
Tensile Impact (ft-lbs/in ²)	D-1822	175,000
Coefficient of Linear Thermal Expansion (in/in/°F)	D-4696	7x10 ⁻⁵

SPIB Design Values for No. 2 Mixed Southern Pine

Extreme Fiber in Bending (psi)	Tension Parallel to Grain (psi)	Horizontal Shear (psi)	Compression Perpendicular to Grain (psi)	Compression Parallel to Grain (psi)	Modulus of Elasticity (psi)
850	550	165	375	525	1,000,000

Uniform Load Table

Span (L) (ft)	Max Allowable Uniform Load (Bending Moment) (lbs/ft)	Deflection Allowable Uniform Load (lbs/ft)			
		L/90	L/180	L/240	L/360
4	1,626	-----	-----	-----	-----
5	1,041	-----	-----	-----	-----
6	723	-----	-----	-----	693
7	531	-----	-----	-----	436
8	406	-----	-----	-----	292
9	321	-----	-----	308	205
10	260	-----	-----	224	150
11	215	-----	-----	169	112
12	181	-----	173	130	87
13	154	-----	136	102	68
14	133	-----	109	82	55
15	116	-----	89	67	44

Physical properties are defined by ASTM testing standards, The Aluminum Association Design Manual, and/or standard engineering practice. The values shown are nominal and may vary. The information found in this document is believed to be true and accurate. No warranties of any kind are made as to the suitability of any CMI product for particular applications or the results obtained there from. ShoreGuard, C-Loc, TimberGuard, GeoGuard, Dura Dock, Shore-All, and Gator Gates are registered trademarks of Crane Materials International. ArmorWare, Ultra Composite, GatorDocks, GatorBridge and CMI Waterfront Solutions are trademarks of Crane Materials International. United States and International Patent numbers 5,145,287; 6,000,883; 6,033,155; 6,053,666; D420,154; 6,575,667; 7,059,807; 7,056,066; 7,025,539; 7,393,482; Other patents pending. © 2009 Crane Materials International. All Rights Reserved.